



INSTALLATION MANUAL

FRONT SPROCKET 24-29 TEETH

JP RGZ 1224/27/28/29 (T-MAX 530 2012/2016)

JP RGZ 1724/25/27/28/29 (T-MAX 530 2017/2019)

JP RGZ 2024/25/27/28/29 (T-MAX 560 2020/-)

JP RGZ 1724/27/28/29 AK (AK 550)

YAMAHA T-MAX 530/560 2012/2020

KYMCO AK 550 2017/2021



WARNING: All Jetprime products are meant for racing use only and should be installed by an expert and skilled mechanic in order to not jeopardize any component or the motorbike operation. Jetprime is not responsible for any issue or damage done by an incorrect assembly, installation or any improper use of its products.

All pictures shown are for illustration purpose only. Actual product may slightly vary due to its enhancement or different colour of the material used for its assembly. The motorcycle shown may be slightly different due to a different color, version or configuration, with also other Jetprime components assembled on it.

Motorbike Preparation

Remove pulley drive assembly and dust cover by unscrewing:

1. central bolt
2. bolts on the left
3. bolts on the right

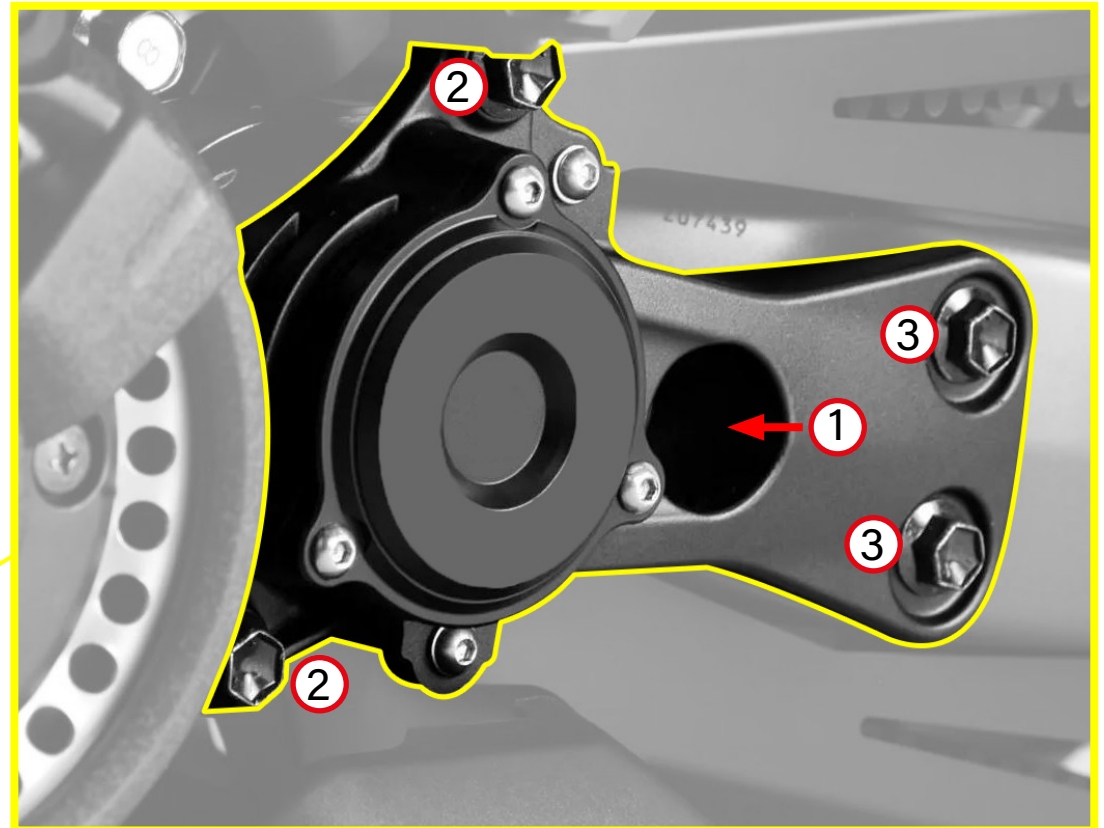

Remove the original pinion from the support using the appropriate extraction tool.

Before assembling it back again, do all the checks prescribed in the Yamaha manual on the transmission belt: if it is worn or deteriorated, belt must be replaced.

Once the support has been removed, it is possible to fit the new JETPRIME pinion, taking care to replace the grease inside the cover with the appropriate lubricating grease and reassembling the unit (previously wrapped in the belt) by tightening again bolt 1, bolts 2 and bolts 3, with 48 Nm of torque (see previous page pictures).

WARNING: carefully check the support for cracks and damage, and clean the dust cover very well before adding fresh grease.

Perform all the operations listed above in reverse order to reassemble the rear wheel.

It's necessary to pay a lot of attention to the **correct tightening** of the belt and to the **correct alignment** of the wheels (see workshop manual): positioning the wheels incorrectly is extremely dangerous for the driver' safety, as well as causing a drastic reduction of the belt life.

END

Attention: the combinations shown in the table below are the only possible ones, otherwise the toothed belt would be either too short or too long.

Coupling Table Crown/Pinion				Yamaha		Kymco
Pinions	Crowns	Ratio	% Ratio	T-MAX 530	T-MAX 560	AK 550
24	60	2,500	-10,2%	X		X
24	59	2,458	-8,3%	X		X
25	60	2,400	-5,8%		X	
26	59	2,269	Originale	X	X	X
26	58	2,231	1,7%	X	X	X
27	60	2,222	-2,1%	X	X	X
27	59	2,185	3,7%	X	X	X
27	58	2,148	5,3%	X	X	X
28	60	2,143	5,6%	X	X	X
27	57	2,111	7,0%	X	X	X
28	59	2,107	7,1%	X	X	X
28	58	2,071	8,7%	X	X	X
29	60	2,069	8,8%	X	X	X
28	57	2,036	10,3%	X	X	X
29	59	2,034	10,3%	X	X	X
29	58	2,000	11,9%	X	X	X
28	56	2,000	11,9%	X	X	X
29	57	1,966	13,4%	X	X	X
29	56	1,931	14,9%	X	X	X

Reference	Theet n°	Compatibility
JP RGZ 1224	24	T-MAX 530 2012/2016
JP RGZ 1227	27	T-MAX 530 2012/2016
JP RGZ 1228	28	T-MAX 530 2012/2016
JP RGZ 1229	29	T-MAX 530 2012/2016
JP RGZ 1724	24	T-MAX 530 2017/2019
JP RGZ 1725	25	T-MAX 530 2017/2019
JP RGZ 1727	27	T-MAX 530 2017/2019
JP RGZ 1728	28	T-MAX 530 2017/2019
JP RGZ 1729	29	T-MAX 530 2017/2019
JP RGZ 2024	24	T-MAX 560 2020/-
JP RGZ 2025	25	T-MAX 560 2020/-
JP RGZ 2027	27	T-MAX 560 2020/-
JP RGZ 2028	28	T-MAX 560 2020/-
JP RGZ 2029	29	T-MAX 560 2020/-
JP RGZ 1724 AK	24	AK 550 2017/2021
JP RGZ 1727 AK	27	AK 550 2017/2021
JP RGZ 1728 AK	28	AK 550 2017/2021
JP RGZ 1729 AK	29	AK 550 2017/2021

All Jetprime products are completely designed and made in Italy.
Thank you for choosing our products.



Visit our store for more application for your bike!
www.jetprimeshop.it



Jetprime S.r.l. (Single Shareholder Company)

Via Eugenio Montale, 1 – 41016 Novi di Modena – Fraz. Rovereto (MO) – Italy

Phone: +39 059 672223 – Email: info@jetprime.it

Jetprime® is a registered trademark. All rights are reserved.