

Yuasa Ficha Técnica

Yuasa STC9-B

Rendimiento

Tensión nominal	12 V
Capacidad (10 h)	9 Ah
Capacidad (20 h)	9.5 Ah
CCA	100 A

Dimensiones (±2mm)

Longitud	137 mm
Anchura	77 mm
Altura	141 mm

Peso

Peso	3 kg
Volumen de ácido	0.6 l

Tecnología

Tecnología	Placa Sb/Sb
Tipo de separador	Hoja



Esquema

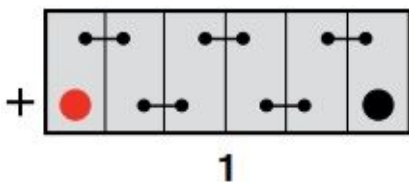

Tipo terminal - 6

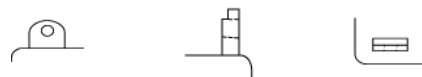

by GSYUASA

www.yuasa.com

Yuasa Technical Data Sheet

Yuasa STC9-B

Performance

Nominal Voltage	12 V
Capacity (10hr)	9 Ah
Capacity (20hr)	9.5 Ah
CCA	100 A

Dimensions (±2mm)

Length	137 mm
Width	77 mm
Height	141 mm



Weights & Measures

Weight	3 kg
Acid Volume	0.6 l

Technology

Technology	Cast Sb/Sb
Separator Type	Hoja

Cell Assembly Layout

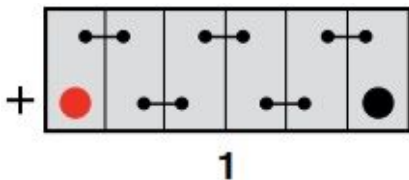

Terminal Type - 6

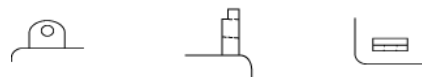

by GSYUASA

www.yuasa.com